

Workshop calipers

Large and solid, stainless steel calipers with no-glare chrome finished scale and vernier.

- Measuring range: 0-2000 mm.
- Vernier: 0.02 mm / 1/1000 inch or 0.05 mm / 1/128 inch.
- Fine adjustment.
- With or without measuring knives for internal or external measurements.
- Rounded jaw ends for internal measurements; measuring range ≤600 mm: $K=10$ mm, measuring range >600 mm: $K=20$ mm.
- DIN 862.
- Delivery in a case with a declaration of conformity.

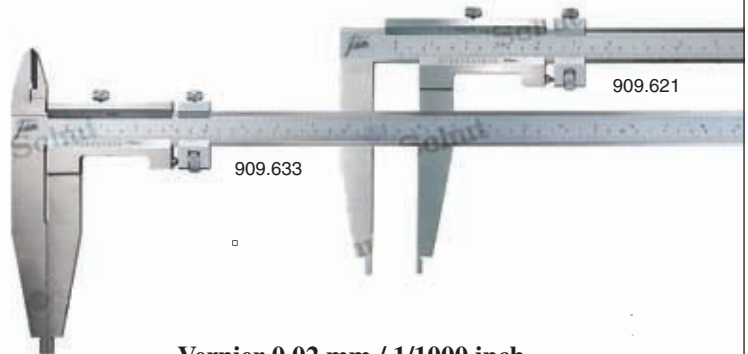
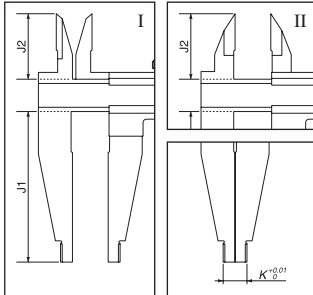

Vernier 0.05 mm / 1/128 inch

| Item No. | Measuring range mm | Length mm | | |
|---|-----------------------|--------------|----|----|
| | | J1 | J2 | K |
| Without measuring knives: | | | | |
| 909.670 | 0- 300 | 90 | - | 10 |
| 909.620 | 0- 450 | 150 | - | 10 |
| 909.621 | 0- 500 | 150 | - | 10 |
| 909.622 | 0- 600 | 150 | - | 10 |
| 909.623 | 0- 800 | 150 | - | 20 |
| 909.624 | 0-1000 | 150 | - | 20 |
| 909.639 | 0-1500 | 200 | - | 20 |
| 909.640 | 0-2000 | 200 | - | 20 |
| Meas. knives for internal measurements (I): | | | | |
| 909.672 | 0- 300 | 90 | 22 | 10 |
| 909.632 | 0- 400 | 100 | 46 | 10 |
| 909.633 | 0- 500 | 150 | 46 | 10 |
| 909.634 | 0- 600 | 150 | 46 | 10 |
| 909.635 | 0- 750 | 150 | 54 | 20 |
| 909.636 | 0-1000 | 150 | 54 | 20 |
| 909.637 | 0-1500 | 200 | 66 | 20 |
| 909.638 | 0-2000 | 200 | 66 | 20 |
| Meas. knives for external measurements (II): | | | | |
| 909.674 | 0- 300 | 90 | 22 | 10 |
| 909.656 | 0- 400 | 100 | 46 | 10 |
| 909.657 | 0- 500 | 150 | 46 | 10 |
| 909.658 | 0- 600 | 150 | 46 | 10 |
| 909.659 | 0- 750 | 150 | 54 | 20 |
| 909.660 | 0-1000 | 150 | 54 | 20 |
| 909.661 | 0-1500 | 200 | 66 | 20 |
| 909.662 | 0-2000 | 200 | 66 | 20 |

Vernier 0.02 mm / 1/1000 inch

| Item No. | Measuring range mm | Length mm | | |
|---|-----------------------|--------------|----|----|
| | | J1 | J2 | K |
| Without measuring knives: | | | | |
| 909.671 | 0- 300 | 90 | - | 10 |
| 909.615 | 0- 450 | 150 | - | 10 |
| 909.616 | 0- 500 | 150 | - | 10 |
| 909.617 | 0- 600 | 150 | - | 10 |
| 909.618 | 0- 800 | 150 | - | 20 |
| 909.619 | 0-1000 | 150 | - | 20 |
| 909.641 | 0-1500 | 200 | - | 20 |
| 909.642 | 0-2000 | 200 | - | 20 |
| Meas. knives for internal measurements (I): | | | | |
| 909.673 | 0- 300 | 90 | 22 | 10 |
| 909.625 | 0- 400 | 100 | 46 | 10 |
| 909.626 | 0- 500 | 150 | 46 | 10 |
| 909.627 | 0- 600 | 150 | 46 | 10 |
| 909.628 | 0- 750 | 150 | 55 | 20 |
| 909.629 | 0-1000 | 150 | 55 | 20 |
| 909.630 | 0-1500 | 200 | 66 | 20 |
| 909.631 | 0-2000 | 200 | 66 | 20 |
| Meas. knives for external measurements (II): | | | | |
| 909.675 | 0- 300 | 90 | 22 | 10 |
| 909.663 | 0- 400 | 100 | 46 | 10 |
| 909.664 | 0- 500 | 150 | 46 | 10 |
| 909.665 | 0- 600 | 150 | 46 | 10 |
| 909.666 | 0- 750 | 150 | 55 | 20 |
| 909.667 | 0-1000 | 150 | 55 | 20 |
| 909.668 | 0-1500 | 200 | 66 | 20 |
| 909.669 | 0-2000 | 200 | 66 | 20 |