

INSERTS FOR DIAL GAUGES, AXIAL PROBES, ETC. - EXECUTION WITH M2,5 THREAD

Spherical measuring inserts, standard.

No	
03510001	Steel
03510002	Carbide
03560001	Sapphire

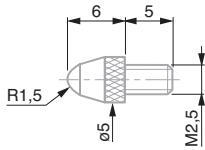

Spherical measuring insert, short

No	
03560007	Carbide

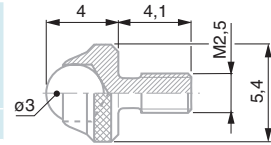

Spherical measuring inserts, long

No	
03560019	Steel
03560020	Carbide
03560021	Ruby

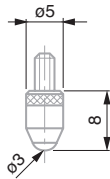

Spherical measuring inserts, R = 0,5 mm.

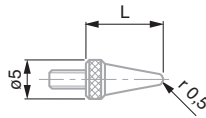

No			L mm
03560035	Steel		5
03560036	Steel		10
03560037	Steel		15
03560038	Steel		20
03560039	Steel		30
03560040	Steel		40

Spherical measuring inserts

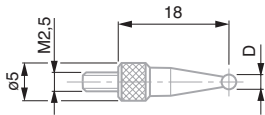

No			D, mm
03560051	Carbide		1
03560052	Carbide		2
03560053	Carbide		3
03560054	Carbide		4
03560055	Carbide		5
03560056	Carbide		6
03560057	Carbide		7
03560058	Carbide		8

Spherical measuring insert with 4 interchangeable pins, R = 1,5 mm

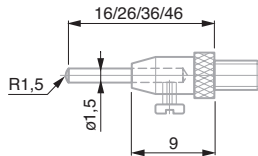

No			L, mm
03510201	Steel		16, 26, 36, 46

Spherical measuring inserts

No	
03510101	Steel
03510102	Carbide

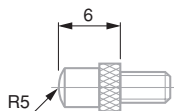

Spherical measuring inserts

No	
03560017	Steel
03560018	Carbide

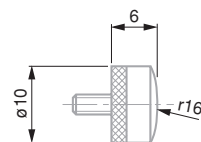

Measuring insert with offset (A)
Pointed measuring face
Lock nut for radial alignment.



03510401 Steel

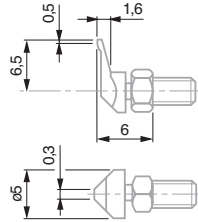

Measuring insert with offset (A)
Pointed measuring face
Lock nut for radial alignment.



03560063 Steel

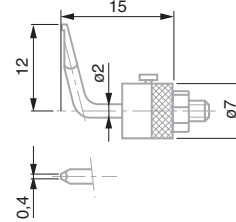

Measuring insert with needle contact point



03560030 Steel

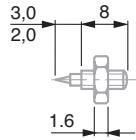

Measuring inserts with ball-bearing rollers
Lock nut for radial alignment

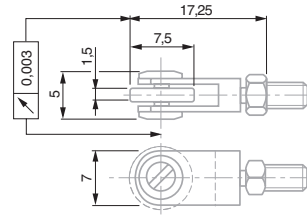

No	Shape	
03560010	Cylindrical	Steel
03560011	Domed	Steel

Inserts with a knife blade measuring face
Lock nut for radial alignment

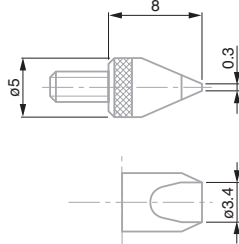

03560024 Steel
03560025 Carbide

Inserts with a knife blade steel face
Lock nut for radial alignment

No	L, mm
03560031	5
03560032	10
03560033	15
03560034	20

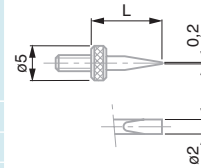

Insert with a cylindrical measuring face
Lock nut for radial alignment



03510502 Carbide

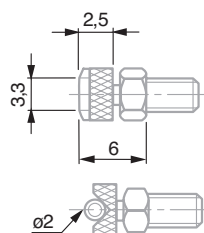

Insert with a narrow, off-centre measuring face
Lock nut for radial alignment



03510602 Carbide

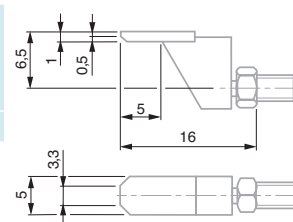

Insert with a narrow measuring face
Parallelism adjustable
Lock nut for radial alignment



03510702 Carbide

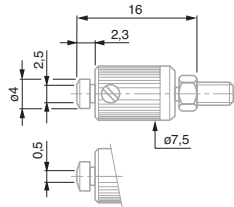

Inserts with a flat measuring face.

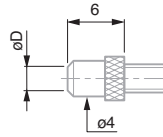

No	Length	Material
03510801	2,5	Steel
03510802	2,5	Carbide
03560022	3,4	Steel
03560023	3,4	Carbide

Insert with a flat measuring face
Parallelism adjustable
Counter-nut for radial alignment



03510902 Métal dur

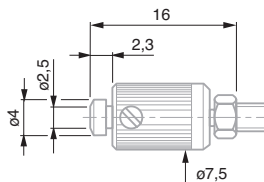

Inserts with a flat measuring face, in steel

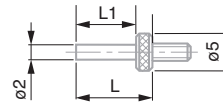

No	L, mm	L1, mm
03560026	5	2,8
03560027	10	7,8
03560028	15	12,8
03560029	20	17,8

Inserts with interchangeable pins
Flat measuring face



03560008 Steel
03560009 Carbide

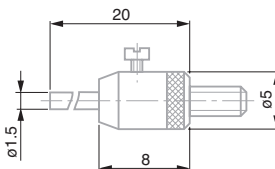

Inserts with flat measuring face

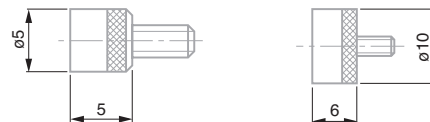

No	Length	Material
03560012	5	Steel
03560013	5	Carbide
03560014	10	Steel
03560015	10	Carbide
03560016	20	Steel

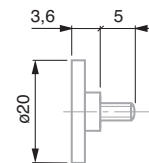

Connectors for measuring inserts

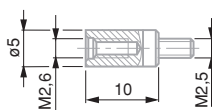

No	Outside	Inside
03560092	M2,5	M2
03560065	M3	M2,5

Extensions for measuring inserts

No	L, mm
03560042	10
03560043	15
03560044	20
03560045	25
03560046	30
03560047	35
03560048	40
03560049	45
03560050	50

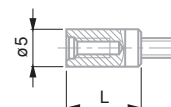

Extensions for measuring inserts.

No	L, mm
03540501	10
03540502	15
03540503	20
03540504	40

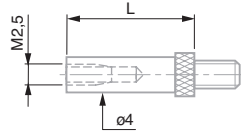

– EXECUTIONS WITH A M2 COUPLING THREAD



Spherical measuring inserts, M2 thread

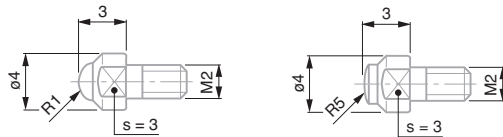

No	mm	
03510204	R 1	Carbide
03510103	R 5	Carbide

Spherical measuring inserts, R = 5 mm, M2 thread

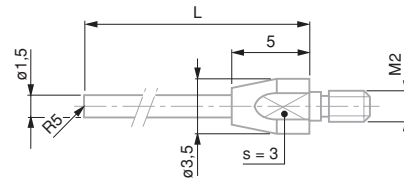

No		L, mm
03510202	Carbide	16
03510203	Carbide	26

Measuring insert with cylindrical measuring face. Lock nut for radial alignment, M2 thread

No	Carbide
03510503	Carbide

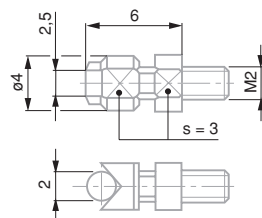

Extensions for measuring inserts, M2

No	L, mm
03540505	10
03540506	15

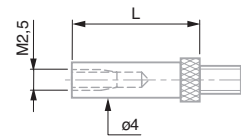

ADDITIONAL ACCESSORIES FOR DIAL GAUGES

Device for plunger retraction for mounting on the bottom stem

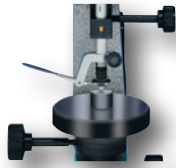

No		Consisting of:
03540104	- 03540101: Lever - 03540102: Washer	



Device for plunger retraction for mounting on the top stem

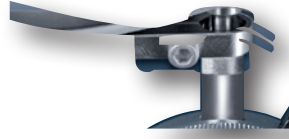

No		mm
03560004	Ø 40	
03560005	Ø 58	



Retraction lever Bottom mounted lift lever

No	=	
01960005	Bottom mounted lift lever	Contains only lifting lever



90° angle probe. For the transmission of movements of the measuring plunger. Max. travel up to 10 mm. For dial gauges of 0,01 mm

No	=	A
03560006	90° angular probe	03560012; Insert with flat measuring face, Ø 5 mm



A Matt chrome plated except for tinted model numbers 01460010, 01460011

Backs for ROCH and ETALON Dial Gauges

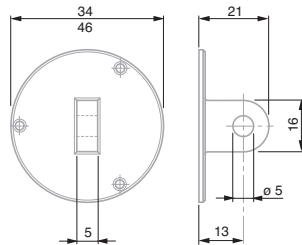

No			A
	Bezel diameter, mm	Back, mm	
01462004	40	34	Back with central lug
01462005	58, 60, 80	46	Back with central lug

Backs for dial gauges TESA YR – YE / MERCER / COMPAC / DIGICO 200-700 – Ø 40 mm dial models

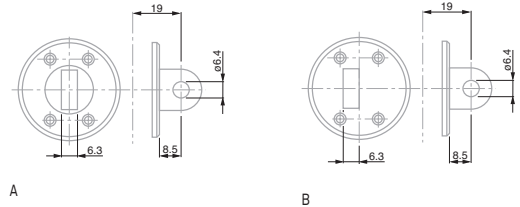

No	A
01460008	A – Back with central lug
01460009	B – Back with offset lug

A Dull chrome-plated except for model numbers 01460016, 01460017.

Backs for dial gauges TESA YR – YE / MERCER / COMPAC / DIGICO 200-700 – Ø 58 and 82mm dial models

No	A
01460014	C – Back with central lug
01460015	D – Back with offset lug

