

Digital dial indicators 0.01 and 0.001 mm

Digital dial indicators for a favourable price.

- Measuring range: 0 - 50 mm.
- Resolution: 0.01 or 0.001 mm.
- mm/inch conversion.
- ABS/INC switchable.
- On/off switch.
- Reset.
- Clamping stem: \varnothing 8 mm.
- Dial diameter: 57 mm.
- Adjustable tolerance limits.
- Flat back and additional back with lug.
- Delivery with an inspection report.
- Power supply: 1 battery type CR2025.



Item No.	Measuring range/mm	Accuracy mm	Price EUR
With resolution 0.01 mm:			
907.634	0 - 12.5	± 0.02	
907.649	0 - 25	± 0.03	
907.652	0 - 50	± 0.04	
With resolution 0.001 mm:			
907.646	0 - 12.5	± 0.015	
Options:			
495.214	Spare battery		
909.446	USB interface		
909.687	Footswitch for USB interface		



USB interface:

- For data transfer to PC (e.g. Excel, Word).
- Operating system: Windows and other.
- PC connection: USB.
- No software or driver to install.
- Foot switch (optional).

005-307-QControl-2011-90702

Absolute digital dial indicators

Absolute digital dial indicators with function to set tolerance limits with clear optical Go (NoGo) reading.

- Measuring range: 0-50 mm.
- Resolution: 0.01 mm or 0.001 mm.
- mm/inch conversion.
- ABS/INC switchable.
- With data output.
- Adjustable tolerance limits.
- **Tolerance display** by means of illuminated green LED at GO value.
- On/off switch.
- Reset/preset.
- Ceramic stylus tip.
- Max. measuring speed: unlimited.
- Clamping stem: \varnothing 8 mm.
- Dial diameter: 60 mm.
- Reversible measuring direction.
- Flat back.
- With additional back with lug.
- Protection: IP54.
- Delivery in a case with an inspection report.
- Power supply: 1 battery type CR2032.



906.870



906.618

NEW

USB interface:

- For data transfer to PC (e.g. Excel, Word).
- Operating system: Windows and other.
- PC connection: USB.
- No software or driver to install.
- Foot switch (optional).



909.687



906.619/910.038

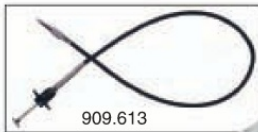

909.613



909.614

Item No.	Measuring range/mm	Resolution mm	Accuracy mm	Price EUR
910.221	0-12.5	0.001	\pm 0.004	
910.222	0-25	0.001	\pm 0.004	
910.223	0-50	0.001	\pm 0.005	
906.870	0-12.5	0.01	\pm 0.01	
906.871	0-25	0.01	\pm 0.01	
906.872	0-50	0.01	\pm 0.015	

Options:

- 495.157 Spare battery
- 906.618 USB interface
- 909.687 Footswitch for USB interface
- 910.038 Wireless USB receiver
- 906.619 Wireless transmitter
- 909.611 Retraction lever
- 909.613 Cable retraction device (0.7 m) (maximum travel 10 mm)
- 909.614 Retraction lever (maximum travel 12.7 mm)

PRICE

C05 330-QControl 20190702

Absolute digital dial indicators

- Measuring range: 0 - 50.8 mm.
- Resolution: 0.01 mm or 0.001 mm.
- mm/inch conversion.
- ABS/INC switchable.
- LCD display 330° rotatable.
- Digimatic data output.
- On/off switch.
- Reset/preset.
- Ceramic stylus tip.
- Max. measuring speed: unlimited.
- Measuring force: ≤ 2 N.
- Clamping stem: $\varnothing 8$ mm.
- Dial diameter: 60 mm.
- Reversible measuring direction.
- With determination of the reversal point (only 910.004).
- Adjustable tolerance limits (except 910.004).
- Flat back.
- With additional back with lug (only 909.998, 910.001/004).
- Protection: IP54.
- Delivery in a case with an inspection report.
- Power supply: 1 battery type CR2032.



USB interface:

- For data transfer to PC (e.g. Excel, Word).
- Operating system: Windows and other.
- PC connection: USB.
- No software or driver to install.
- Foot switch (optional).



Item No.	Measuring range/mm	Resolution mm	Accuracy mm	Price EUR
909.998	0 - 12.7	0.001	± 0.004	
909.999	0 - 25.4	0.001	± 0.005	
910.000	0 - 50.8	0.001	± 0.006	
910.001	0 - 12.7	0.01	± 0.01	
910.002	0 - 25.4	0.01	± 0.01	
910.003	0 - 50.8	0.01	± 0.015	
For internal measurements:				
910.004	0 - 12.7	0.001	± 0.004	
With Bluetooth:				
910.079	0 - 12.7	0.001	± 0.004	
910.082	0 - 12.7	0.01	± 0.01	
Options:				
495.157	Spare battery			
909.686	USB interface			
909.687	Footswitch for USB interface			
910.038	Wireless USB receiver			
910.039	Wireless transmitter			
909.611	Retraction lever			
909.613	Cable retraction device (0.7 m) (maximum travel 10 mm)			
909.614	Retraction lever (maximum travel 12.7 mm)			

C05 326-QControl 20180702

Digital dial indicators

Digital dial indicators with digital and digital-analog read-out.

- Measuring range: 0-12.5 mm.
- Resolution: 0.002 or 0.001 mm.
- mm/inch conversion.
- ABS/INC switchable.
- On/off switch.
- Automatic switch-off.
- Reset/preset.
- Clamping stem: \varnothing 8 mm.
- Dial diameter: 62 mm.
- Dial 360° rotatable.
- Reversible measuring direction.
- With determination of the reversal point.
- Adjustable tolerance limits.
- Power supply: 1 battery type CR2032.



909.251

Item No.	Measuring range/mm	Resolution mm	Accuracy mm	Measuring force/N	Price EUR
909.250	0-12.5	0.002	\pm 0.015	1.8-3.0	
909.251	0-12.5	0.001	\pm 0.006	2.2-3.5	
Option:					
495.157 Spare battery					

Digital dial indicators

Universal digital indicators with both digital and digital-analog display of the measuring value, and can also be rotated over 340° to ensure easy read-out in all positions.

- Measuring range: 0-12.7 mm.
- Resolution: 0.001 mm.
- Analog resolution: 0.001/0.002/0.01/0.02/0.05 mm.
- mm/inch conversion.
- ABS/INC switchable.
- On/off switch.
- Automatic switch-off.
- Reset/preset.
- Clamping stem: \varnothing 8 mm.
- Dial diameter: 61 mm.
- Dial 340° rotatable.
- Reversible measuring direction.
- Adjustable tolerance limits.
- Protection: IP54.
- Power supply: 1 battery type CR2032.



907.879

Item No.	Measuring range/mm	Accuracy mm	Price EUR
907.879	0-12.7	\pm 0.01	
907.878	0-12.7	\pm 0.005	
Option:			
495.157 Spare battery			



C05 320_QControl 20180702

Absolute horizontal digital dial indicators

- Measuring range: 0-30 mm.
- Resolution: 0.001 mm.
- mm/inch conversion.
- Digimatic data output.
- On/off switch.
- Reset/preset.
- Ceramic stylus tip.
- With dovetail joint (incl. lug) and clamping stem \varnothing 8 mm.
- Measuring force: \leq 2 N.
- Reversible measuring direction.
- Protection: IP54.
- Delivery in a case with an inspection report.
- Power supply: 1 battery type CR1632.

USB interface and wireless USB receiver and transmitter available on request.



Item No.	Measuring range/mm	Resolution mm	Accuracy mm	Price EUR
910.085	0-12.7	0.001	\pm 0.005	
910.086	0-30	0.001	\pm 0.006	
Option:				
497.955	Spare battery			



Digital dial indicator with calculation function

Robust digital dial indicator with built-in calculation function for easy determination of diameters by means of measuring a curved surface. Suitable for measuring both inside and outside diameters and multifunctional dial indicator applications. Delivery with measuring bases of 10, 20, 30, 60 and 100 mm.

- Measuring range: 0-13 mm.
- Resolution: 0.005 mm.
- mm/inch conversion.
- On/off switch.
- Reset.
- Hold function.
- Clamping stem: \varnothing 8 mm.
- Aluminum construction.
- Delivery in a case.
- Power supply: 1 battery type CR2032.



Item No.	Measuring range/mm	Accuracy mm	Price EUR
907.884	0-13	\pm 0.005*	
Option:			
495.157	Spare battery		



* Accuracy of the indicator without the use of measuring bases. The accuracy with measuring bases depends on the radius and form deviation of the workpiece.

C05 329 QControl 20180702

Dial indicators 0.01 mm

Indicators with an excellent price-performance ratio.

- Measuring range: 0 - 10 mm.
- Graduation: 0.01 mm.
- Clamping stem: \varnothing 8 mm.
- Dial diameter: 55 mm.
- Rotatable dial.
- Shockproof.
- Adjustable tolerance markers.
- Flat back.
- Delivery with an inspection report.
- Retraction lever available on request (only 907.929/930).



907.930



Item No.	Measuring range/mm	Price EUR
907.928	0 - 3	
907.929	0 - 5	
907.930	0 - 10	
Option:		
908.799	Back with lug	

Dial indicators 0.01 mm

Indicators with a large dial and a locking screw. Shockproof design.

- Measuring range: 0 - 10 mm.
- Graduation: 0.01 mm.
- Clamping stem: \varnothing 8 mm.
- Dial diameter: 60 mm.
- Rotatable dial.
- Shockproof.
- Adjustable tolerance markers.
- Locking screw.
- Flat back.
- Delivery with an inspection report.



NEW



907.933

907.933
+906.359



Item No.	Measuring range/mm	Price EUR
907.931	0 - 3	
907.932	0 - 5	
907.933	0 - 10	
Options:		
908.987	Back with lug	
906.359	Retraction lever	



C05 306 QControl 20180702

Dial indicators 0.01 mm

Indicators with a large measuring range. Shockproof design.

- Measuring range: 0 - 100 mm.
- Graduation: 0.01 mm.
- Clamping stem: \varnothing 8 mm.
- Rotatable dial.
- Shockproof.
- Adjustable tolerance markers (except 907.916).
- Locking screw.
- Flat back.
- Delivery with an inspection report.



907.934



907.936

907.935



907.916

Item No.	Measuring range/mm	Dial \varnothing /mm	Price EUR
907.934	0 - 25	60	
907.935	0 - 30	60	
907.936	0 - 50	76	
907.916	0 - 100	80	

Options:

- 908.987¹ Back with lug
- 908.988² Back with lug

¹ For 907.934/935.

² For 907.936/916.



Splashproof dial indicators 0.01 mm

Indicators with splashproof design.

- Measuring range: 0 - 10 mm.
- Graduation: 0.01 mm.
- Clamping stem: \varnothing 8 mm.
- Dial diameter: 55 mm.
- Rotatable dial.
- Shockproof.
- Adjustable tolerance markers.
- Locking screw.
- Back with lug.
- Protection: IP54.
- Conforms to factory standard.



908.779



Item No.	Measuring range/mm	Price EUR
908.777	0 - 3	
908.778	0 - 5	
908.779	0 - 10	



C05 903 QControl 3190702

Miniature dial indicators 0.01 and 0.001 mm

Indicators with very small dimensions and an excellent price-performance ratio. Shockproof design.

- Measuring range: 0-10 mm.
- Graduation: 0.01 or 0.001 mm.
- Clamping stem: \varnothing 8 mm.
- Dial diameter: 40 mm.
- Rotatable dial.
- Shockproof.
- Adjustable tolerance markers.
- Locking screw.
- Flat back.
- Delivery with an inspection report.



Item No.	Measuring range/mm	Price EUR
Graduation 0.01 mm:		
907.925	0- 3	
907.926	0- 5	
907.927	0- 8	
907.914	0-10	
Graduation 0.001 mm:		
907.920	0- 1	
Option:		
908.986	Back with lug	



Dial indicators 0.001 mm

Indicators with micrometer reading. Shockproof design.

- Measuring range: 0-5 mm.
- Graduation: 0.001 mm.
- Clamping stem: \varnothing 8 mm.
- Dial diameter: 60 mm.
- Rotatable dial.
- Scale numbering: 0-100-0.
- Shockproof.
- Adjustable tolerance markers.
- Locking screw.
- Flat back.
- Delivery with an inspection report.



Item No.	Measuring range/mm	Price EUR
907.921	0-1	
907.922	0-2	
907.923	0-3	
907.924	0-5	
Option:		
908.987	Back with lug	



005 311 QControl.gr

Peacock dial indicators 0.1 and 0.01 mm

- Measuring range: 0-80 mm.
- Graduation: 0.1 or 0.01 mm.
- Clamping stem: ϕ 8, 10 or 14 mm.
- Rotatable dial.
- Adjustable tolerance markers.
- Flat back or back with lug*.
- DIN 878.
- Delivery in a case.

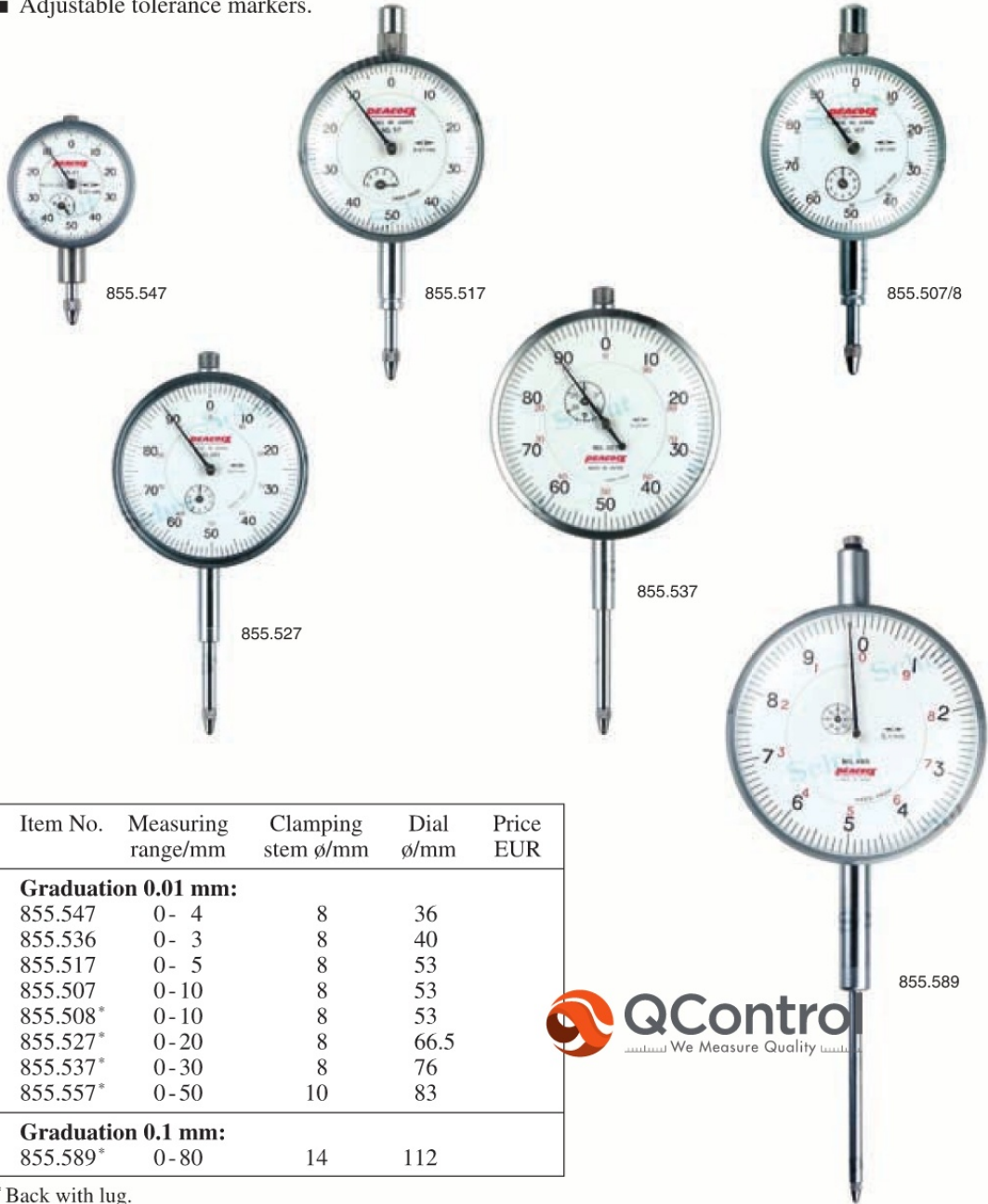

Item No.	Measuring range/mm	Clamping stem ϕ /mm	Dial ϕ /mm	Price EUR
Graduation 0.01 mm:				
855.547	0- 4	8	36	
855.536	0- 3	8	40	
855.517	0- 5	8	53	
855.507	0-10	8	53	
855.508*	0-10	8	53	
855.527*	0-20	8	66.5	
855.537*	0-30	8	76	
855.557*	0-50	10	83	
Graduation 0.1 mm:				
855.589*	0-80	14	112	



* Back with lug.

C05 2118 QControl 20180702

Peacock dial indicators 0.005 and 0.001 mm

- Measuring range: 0-5 mm.
- Graduation: 0.005 or 0.001 mm.
- Clamping stem: \varnothing 8 mm.
- Rotatable dial.
- Flat back or back with lug*.
- DIN 878.
- Delivery in a case.

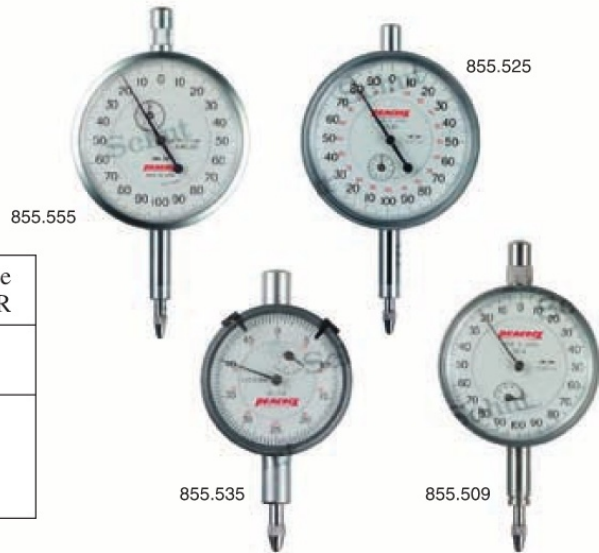

Item No.	Measuring range/mm	Dial \varnothing /mm	Price EUR
Graduation 0.005 mm:			
855.535*	0-3	47	
Graduation 0.001 mm:			
855.509	0-1	53	
855.525*	0-2	66.5	
855.555*	0-5	66.5	

* Back with lug.

Peacock dial indicators with back plunger

The back plunger dial indicator is characterized with easy handling since the spindle with the contact point is moving in the direction perpendicular to the dial face and the gauge is more compact. The dial indicator of this type is convenient for use in achieving a parallelism of the table of the machine tool, with measuring jigs, in restricted areas and on locations where scale reading is difficult.

- Measuring range: 0-5 mm.
- Graduation: 0.01 mm.
- Repeatability: 0.005 mm.
- Hysteresis: \pm 0.006 mm.
- Measuring force: 1.4 N.
- Rotatable dial.
- Scale numbering: 0-100.
- DIN 878.
- Delivery in a case.

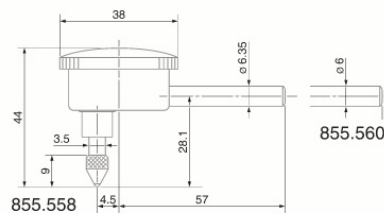

Item No.	Measuring range/mm	Clamping stem \varnothing /mm	Accuracy mm	Price EUR
855.558	0-5	6.35	\pm 0.02	
855.560	0-5	6	\pm 0.02	
Clamping stem on back side:				
855.559	0-5	8	\pm 0.02	



C05 2119 QControl 20180702

Precision dial indicator

Highly accurate shockproof dial indicator for measurements from a fixed reference point. Very suitable for internal measuring instruments and dial indicator stands for example.

- Measuring range: 0.1 mm.
- Graduation: 0.001 mm.
- Measuring force: <2 N.
- Clamping stem: \varnothing 8 mm.
- Travel: 3 mm.
- Adjustable tolerance markers.
- Fine adjustment.
- Delivery with an inspection report.



Item No.	Measuring range/mm	Dial \varnothing /mm	Price EUR
907.939	0.1	63.5	



Precision dial indicators

- Measuring range: 0.06 mm.
- Graduation: 0.0005 mm or 0.001 mm.
- Measuring force: approx. 1 N.
- Clamping stem: \varnothing 28 mm.
- Shockproof.
- Fine adjustment.
- Delivery with an inspection report.



Item No.	Measuring range/mm	Resolution mm	Scale numbering	Price EUR
906.332	0.03	0.0005	15 - 0 - 15	
906.333	0.06	0.001	30 - 0 - 30	

906.333

C05 2115 QControl 20190702

Inserts

Inserts with thread M2.5. The inserts are made of steel unless otherwise indicated; tungsten carbide (TC), ruby (R) or sapphire (S).

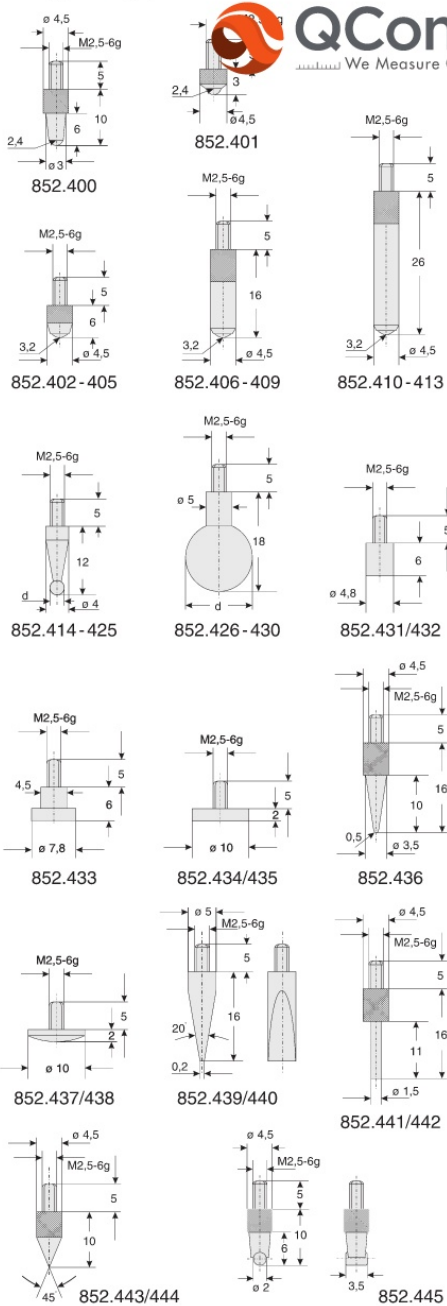

Item No.	Description	Price EUR
Ball probes:		
852.400	d= 2.4 mm l= 10 mm	
852.401	d= 2.4 mm l= 3.0 mm	
852.402	d= 3.2 mm l= 6.0 mm	
852.403	d= 3.2 mm l= 6.0 mm	TC
852.404	d= 3.2 mm l= 6.0 mm	R
852.405	d= 3.2 mm l= 6.0 mm	S
852.406	d= 3.2 mm l= 16 mm	
852.407	d= 3.2 mm l= 16 mm	TC
852.408	d= 3.2 mm l= 16 mm	R
852.409	d= 3.2 mm l= 16 mm	S
852.410	d= 3.2 mm l= 26 mm	
852.411	d= 3.2 mm l= 26 mm	TC
852.412	d= 3.2 mm l= 26 mm	R
852.413	d= 3.2 mm l= 26 mm	S
852.414	d= 1.0 mm l= 12 mm	
852.420	d= 1.0 mm l= 12 mm	TC
852.415	d= 2.0 mm l= 12 mm	
852.421	d= 2.0 mm l= 12 mm	TC
852.416	d= 3.0 mm l= 12 mm	
852.422	d= 3.0 mm l= 12 mm	TC
852.417	d= 4.0 mm l= 12 mm	
852.423	d= 4.0 mm l= 12 mm	TC
852.418	d= 5.0 mm l= 12 mm	
852.424	d= 5.0 mm l= 12 mm	TC
852.419	d= 6.0 mm l= 12 mm	
852.425	d= 6.0 mm l= 12 mm	TC
852.426	d= 7.0 mm l= 18 mm	
852.427	d= 8.0 mm l= 18 mm	
852.428	d= 9.0 mm l= 18 mm	
852.429	d= 10.0 mm l= 18 mm	
852.430	d= 11.0 mm l= 18 mm	
Flat probes:		
852.431	d= 4.8 mm l= 6 mm	
852.432	d= 4.8 mm l= 6 mm	TC
852.433	d= 7.8 mm l= 6 mm	
852.434	d= 10.0 mm l= 2 mm	
852.435	d= 10.0 mm l= 2 mm	TC
Spherical probes:		
852.436	conical l= 16 mm	
852.437	d= 10.0 mm l= 2.0 mm	
852.438	d= 10.0 mm l= 2.0 mm	TC
Knife-edged probes:		
852.439	d= 5.0 mm l= 16 mm	
852.440	d= 5.0 mm l= 16 mm	TC
Needle-shaped probes:		
852.441	d= 1.5 mm l= 16 mm	
852.442	d= 1.5 mm l= 16 mm	TC
Tapered probes:		
852.443	d= 4.5 mm l= 10 mm point 45°	
852.444	d= 4.5 mm l= 10 mm point 45°	TC
Probe with cylindrical measuring face:		
852.445	d= 2 x 3.5 mm l= 10 mm	

C05 231-QControl 20190702

Extensions for inserts

Steel extensions for inserts with thread M2.5.

Item No.	Length mm	Price EUR
Extensions with A = ϕ 4 mm:		
852.446	10	
852.447	15	
852.448	20	
852.449	25	
852.450	30	
852.451	35	
852.452	40	
852.453	45	
852.454	50	
852.455	55	
852.456	60	
852.457	65	
852.458	70	
852.459	75	
852.460	80	
852.461	85	
852.462	90	
852.463	95	
852.464	100	

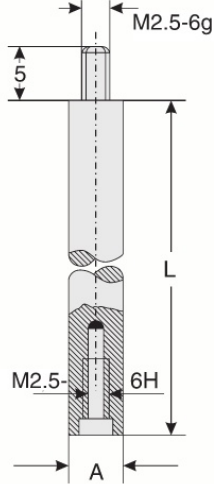

Item No.	Length mm	Price EUR
Extensions with A = ϕ 5 mm:		
852.465	10	
852.466	15	
852.467	20	
852.468	25	
852.469	30	
852.470	35	
852.471	40	
852.472	45	
852.473	50	
852.474	55	
852.475	60	
852.476	65	
852.477	70	
852.478	75	
852.479	80	
852.480	85	
852.481	90	
852.482	95	
852.483	100	

Adapters for inserts

Adapter for attaching other inserts to dial indicators and probes with an interchangeable insert with thread M2.5.

Item No.	External/internal thread	Price EUR
960.276	M2.5/M2	

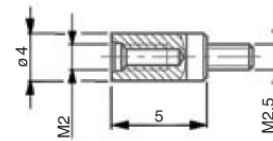

Depth measuring bases for dial indicators

Bases which make dial indicators and probes suitable for depth measurements.

- Clamping shaft: 8H7.

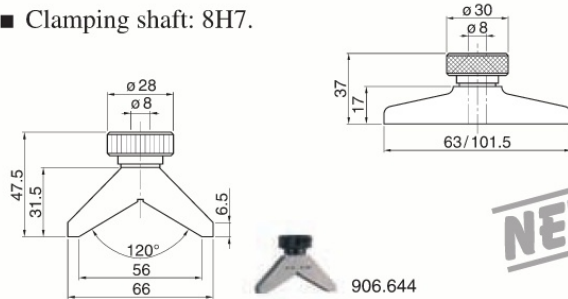

907.153

NEW

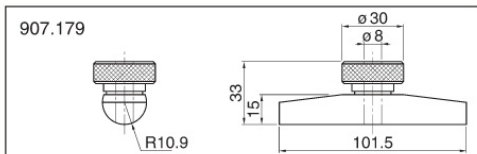

Item No.	Measuring face l x w/mm	Price EUR
907.153	63 x 17	
907.165	101.5 x 17	
906.644	66 x 16	
With cylindrical measuring face:		
907.179	101.5 x R10.9	

C05.232-QControl.20180702

Lever-type test indicators

- Measuring range: up to 0.8 mm.
- Graduation: 0.01 or 0.002 mm.
- With dovetail joint and clamping stems $\phi 6$ and $\phi 8$ mm.
- Dial diameter: 40 mm.
- Rotatable dial.
- Stylus tip: $\phi 2$ mm.
- Delivery with an inspection report.

NEW

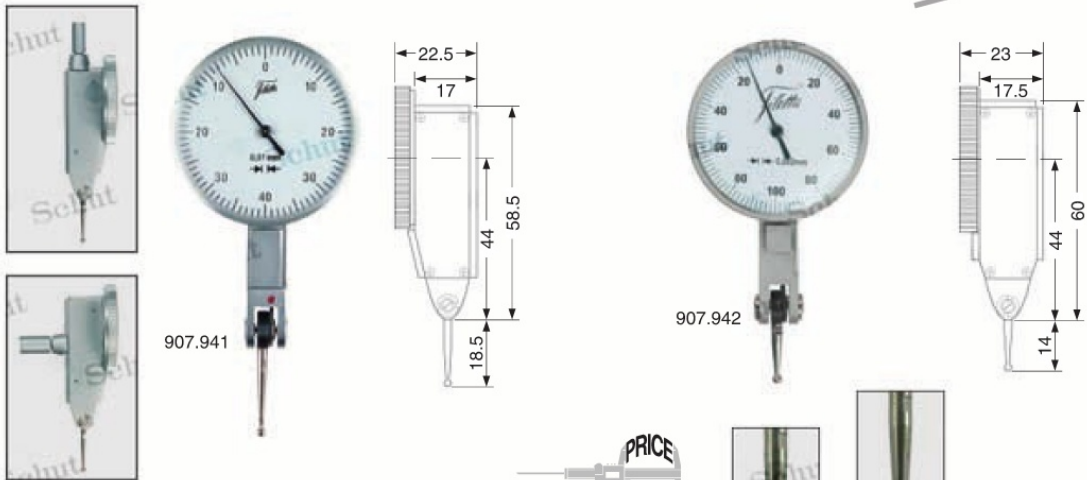

Item No.	Measuring range/mm	Graduation mm	Scale numbering	Insert length/mm	Price EUR
907.941	0.8	0.01	0-40-0	19	
907.942	0.2	0.002	0-100-0	13	

Options:

- 909.114 Steel spare stylus tip for 907.941
- 909.115 Steel spare stylus tip for 907.942
- 906.663 Ruby spare stylus tip for 907.941
- 906.664 Ruby spare stylus tip for 907.942



Lever-type digital test indicator

Lever-type digital test indicator with tolerance judgement. Suitable for measurements in both directions. Equipped with three dovetail mountings.

- Measuring range: up to 0.5 mm.
- Resolution: 0.001 mm.
- Accuracy: ± 0.02 mm.
- mm/inch conversion.
- On/off switch.
- Reset.
- Measuring force: ≤ 0.6 N.
- With dovetail joint and clamping stems $\phi 6$ and $\phi 8$ mm.
- Ruby stylus tip: $\phi 2$ mm.
- 230° adjustable measuring insert.
- Adjustable tolerance limits.
- Power supply: 1 battery type V357.



Item No.	Measuring range/mm	Resolution mm	Insert length/mm	Price EUR
907.574	0.5	0.001	17	

Options:

- 836.535 Spare battery
- 907.769 Spare stylus tip



Peacock lever-type dial test indicators

- Measuring range: up to 1 mm.
- Graduation: 0.01, 0.002 or 0.001 mm.
- With dovetail joint and clamping stem $\varnothing 6$ mm.
- Measuring force: <0.3 N (except 855.610: 0.05 N).
- Tungsten carbide stylus tip: $\varnothing 2$ mm.
- Insert thread: M1.7.

Inserts for lever-type dial test indicators

Item No.	Effective length (EL)/mm	Ball \varnothing /mm	Price EUR
For 855.601, 855.605 and 855.610:			
859.016	17.74	2	
859.152	17.74	1	
859.151	17.74	0.8	
859.290	17.74	0.5	
For 855.602:			
859.126	39.00	2	
859.291	39.00	1	
859.292	39.00	0.8	
859.293	39.00	0.5	
For 855.603 and 855.606:			
859.200	14.33	2	
859.294	14.33	1	
859.295	14.33	0.8	
859.296	14.33	0.5	
For 855.604:			
859.259	8.13	2	
859.297	8.13	1	
859.298	8.13	0.8	
859.299	8.13	0.5	
For 855.611:			
859.464	19.24	2	
859.465	19.24	1	
859.466	19.24	0.8	
859.467	19.24	0.5	

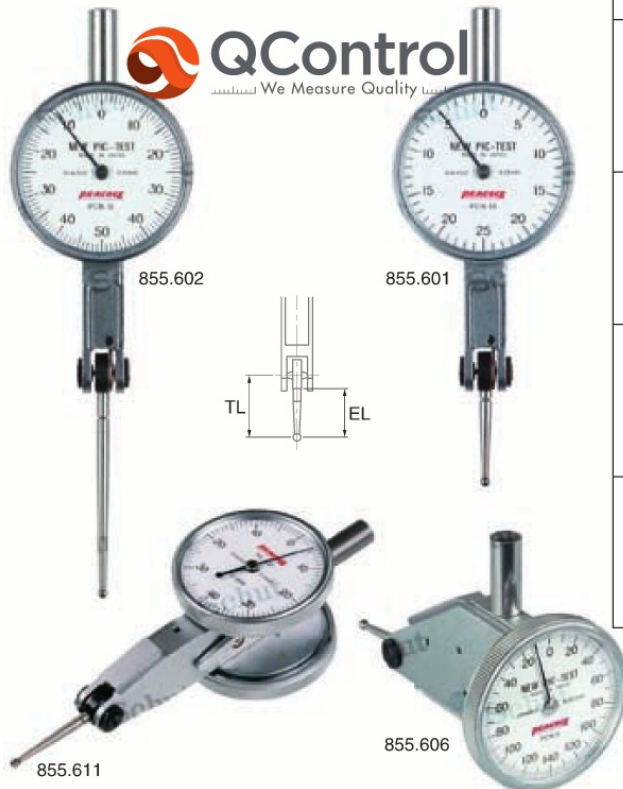

Item No.	Measuring range/mm	Graduation mm	Dial \varnothing /mm	Scale numbering	Insert	Total insert length (TL)/mm	Price EUR
Horizontal:							
855.601	0.5	0.01	35	0-25-0	859.016	21.3	
855.602	1	0.01	35	0-50-0	859.126	42.8	
855.603	0.28	0.002	35	0-140-0	859.200	17.9	
855.604	0.14	0.001	35	0-70-0	859.259	11.7	
855.611	0.8	0.01	35	0-40-0	859.464	22.4	
855.610	0.5	0.01	35	0-25-0	859.016	21.3	
Perpendicular:							
855.605	0.5	0.01	35	0-25-0	859.200	21.3	
855.606	0.28	0.002	35	0-140-0	859.200	17.9	

C05 225-QControl 20180702

Accessories dial indicators/dial test indicators

Item No.	Description	Price EUR
909.433	Centering support $\phi 8 \times 25$ mm, holder $\phi 4$ mm	
909.434	Rectangular fixing shaft $12 \times 6 \times 76$ mm, holder $\phi 4/\phi 8$ mm and dovetail clamp	
909.435	Rectangular fixing shaft $12 \times 6 \times 76$ mm, holder $\phi 6/\phi 8$ mm and dovetail clamp	
909.436	Rectangular fixing shaft $9 \times 9 \times 76$ mm, holder $\phi 4/\phi 8$ mm and dovetail clamp	
909.437	Rectangular fixing shaft $9 \times 9 \times 76$ mm, holder $\phi 6/\phi 8$ mm and dovetail clamp	
909.438	Round, swivelling fixing shaft $\phi 6 \times 70$ mm, holder with dovetail clamp	
909.439	Round, swivelling fixing shaft $\phi 8 \times 70$ mm, holder with dovetail clamp	

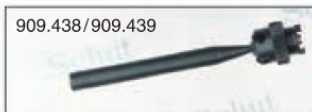

Reducer



837.190



Item No.	Thread	Price EUR
781.819	$\phi 8 \rightarrow 4$ mm	
837.190	$\phi 8 \rightarrow 6$ mm	

Center-accessory

Small magnetic dial indicator stand which, in combination with a lever, could also be used as center-accessory to align bores in workpieces. For use in combination with a machine center.

- Permanent magnet $\phi 27$ mm.
- Universal pivot with dovetail clamp.
- Delivery incl. cylindrical support $\phi 9.5$ mm for insert in the collet chuck of a machine center.



Item No.	Description	Price EUR
781.997	Center-accessory	